

# Z-client1080

1920X1080 Zero Client Multipoint Device

**VideoHome Technology Corp.**

4F-1, No. 190/192, Sec. 3, Datong Rd., Xizhi Dist.,

New Taipei City 221, Taiwan

**Tel:** 886-2-8647-1876

**Fax:** 886-2-8647-2841

**E-mail:** sales@videohome.com.tw

**Http://**www.videohome.com.tw

Catalog

## Introduction

Z-client1080 is a zero client designed as a multi-user sharing resource system device, each Z-client1080 device support upto 1920x1080 display output (HDMI or VGA). Based on Windows® Multipoint® Server operating system, the solution enables a host server to power multiple independent client stations. Each client station only consists of one Z-client1080 with a keyboard, mouse, and monitor connected, allowing multiple users to share the computing power of one single server. Simply through a USB connection, the server provides each station user with a familiar and independent Windows experience operation.



## Z-client1080 Application

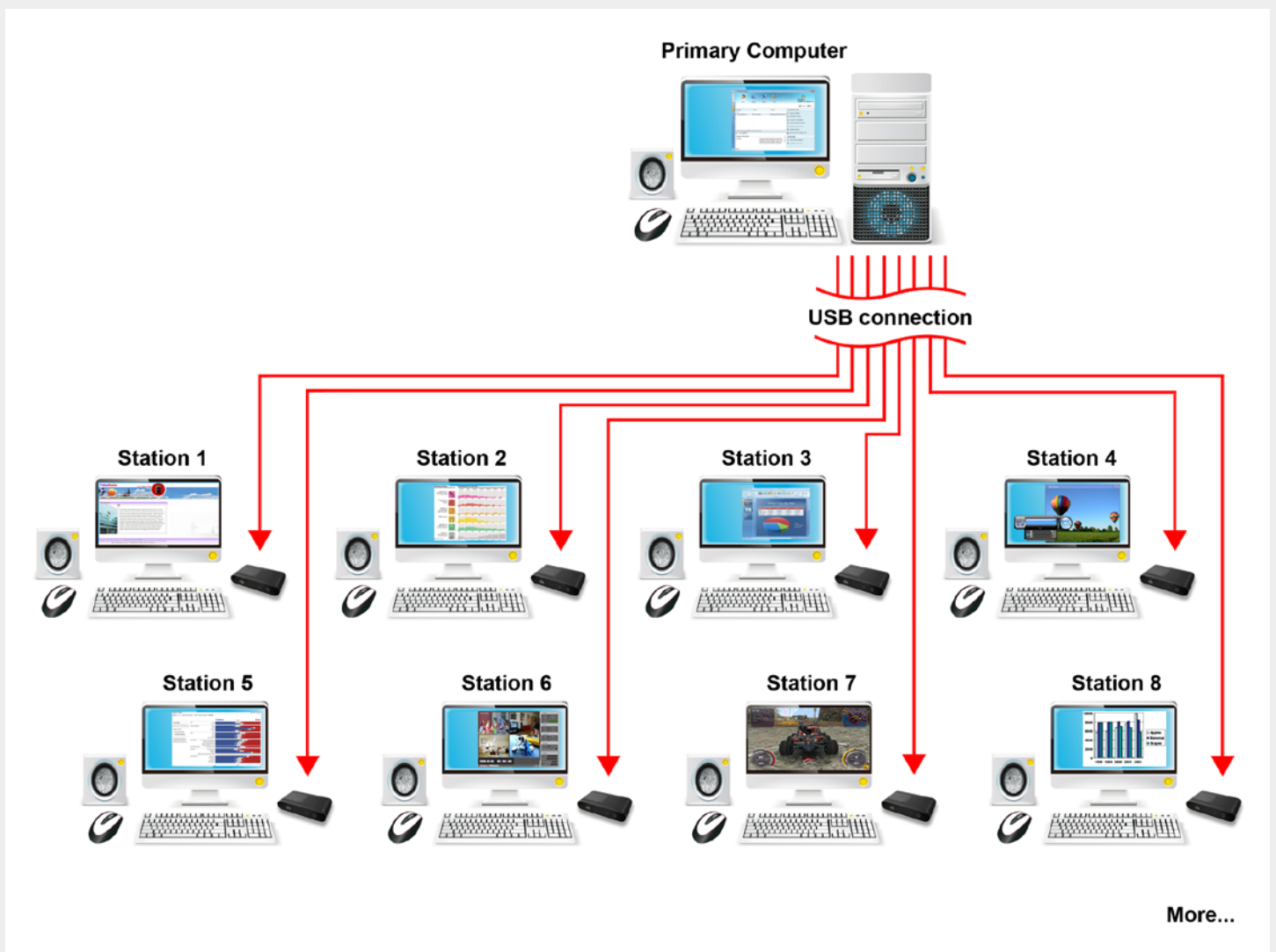

## Features

- Appropriate for Zero Client application
- Alternatively outputs HDMI or VGA
- Delivers smooth high-resolution up to 1920 x 1080
- Support up to 14 users  
(Special driver for Windows® Multipoint® Server 2011) or 10 users  
(Device drivers are native to Useful MultiSeat Linux 2011)
- Two USB ports let you connect your most used peripheral (e.g. Mouse/Keyboard..)
- Microphone input port and Earphone (or Speaker) jack (green) output for easy Skype/MSN using

## Specifications

- Video:
  - Display output supported both HDMI and VGA (Alternatively)
  - Supports resolution up to 1920 x 1080
- USB:
  - Upstream connector: Mini-B type x 1
  - Peripherals: USB 2.0 x 2
- Audio :
  - HDMI digital audio out
  - Earphone (or Speaker) jack (green) out
  - Microphone jack (pink) in
- Power requirement : DC5V
- Dimensions : 133 x 71 x 27 (mm)

## Host server system requirements

- Windows® Multipoint® Server 2011 or Useful MultiSeat Linux 2011
- Equipped USB2.0 Notebook/Desktop computer
- CD-ROM drive (For software installation)
- CPU and Memory

Application scenario	Up to 4 stations	5-6 stations	7-10 stations	11-14 stations
<b>Productivity</b> Office, Web browsing, line-of-business	<b>CPU:</b> 2C	<b>CPU:</b> 2C	<b>CPU:</b> 4C	<b>CPU:</b> 4C
	<b>RAM:</b> 2GB	<b>RAM:</b> 4GB	<b>RAM:</b> 6GB	<b>RAM:</b> 8GB
<b>Mixed</b> Productivity plus: Occasional video use by some users	<b>CPU:</b> 2C	<b>CPU:</b> 2C	<b>CPU:</b> 4C	<b>CPU:</b> 4C+MT or 6C
	<b>RAM:</b> 2GB	<b>RAM:</b> 4GB	<b>RAM:</b> 6GB	<b>RAM:</b> 8GB
<b>Video intensive2</b> Productivity plus: Frequent video use by all users	<b>CPU:</b> 2C	<b>CPU:</b> 4C	<b>CPU:</b> 4C+MT or 6C	<b>CPU:</b> 4C+MT or 6C
	<b>RAM:</b> 2GB	<b>RAM:</b> 4GB	<b>RAM:</b> 6GB	<b>RAM:</b> 8GB

## Notes:

- 2C = 2 cores, 4C = 4 cores, 6C = 6 cores, MT = Multi-threading. Processor speed should be at least 2.0 gigahertz (GHz).

## Package Contents

- Z-client1080 docking station x 1
- DC5V power adapter x 1
- USB A to mini B cable 300 cm x 1
- Driver / Manual CD x 1
- Quick Installation Guide x 1