

User Manual for Solar-Powered Multi-beam Active Wireless Infrared Light Walls

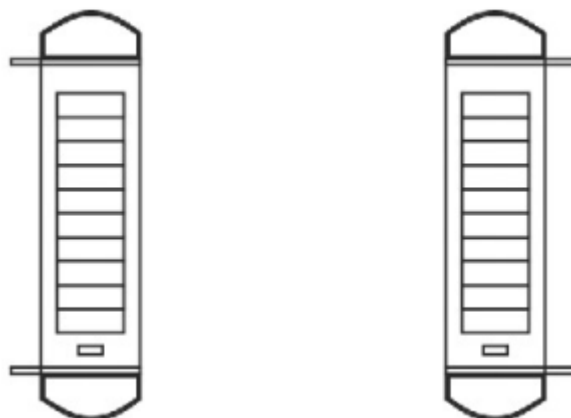

HB-T001Q3

HB-T001R3

1、 Product Overview

Solar-powered multi-beam active wireless infrared light walls for engineering applications is a new-type hi-tech environmentally-friendly product and has obtained national patent. It applies sun's UV rays to supply power and charge for itself, and adopts the wireless signal transmission device to transmit alarm signal instead of power cable and signal line. It is widely installed in houses, schools, workshops and perimeter fencing of residential quarters etc.

2、 Name of Parts

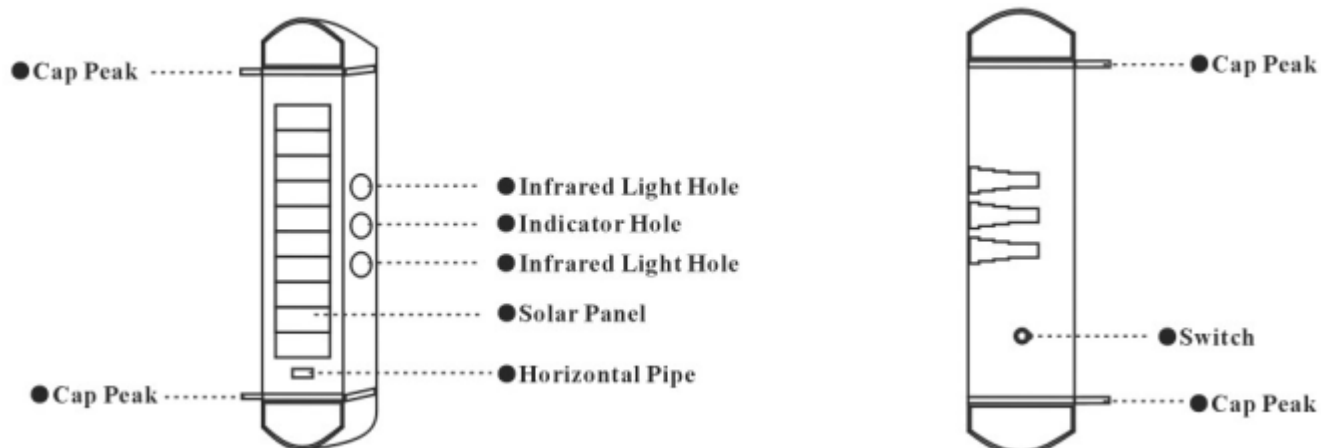

3、 Installation Precautions

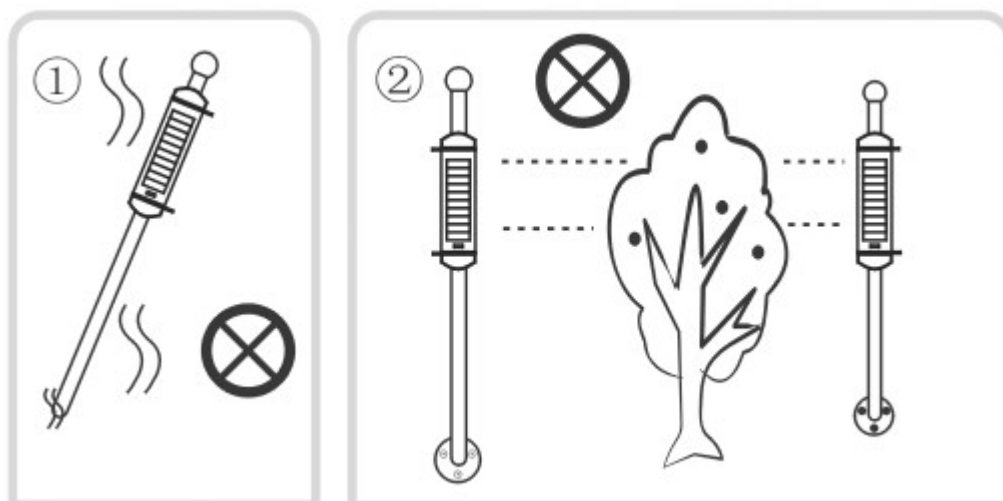

Note 1: Never install light walls at an inclined angle.

Note 2: Make sure that there is no obstacle between the transmitting terminal and the receiving terminal.

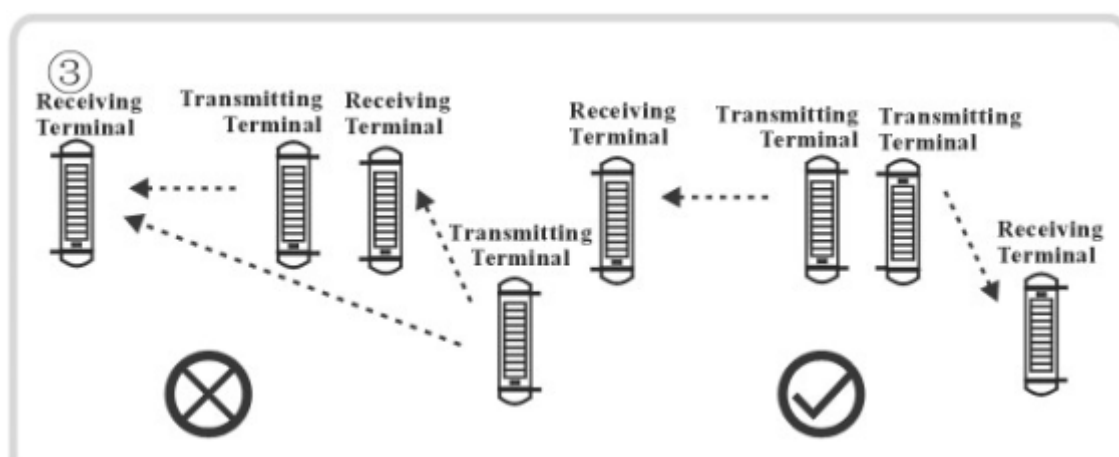

Note 3: Multiple light walls shall be installed for long-distance alarm in accordance with the installation instructions shown in the above-mentioned figure to avoid mutual interference among beams.

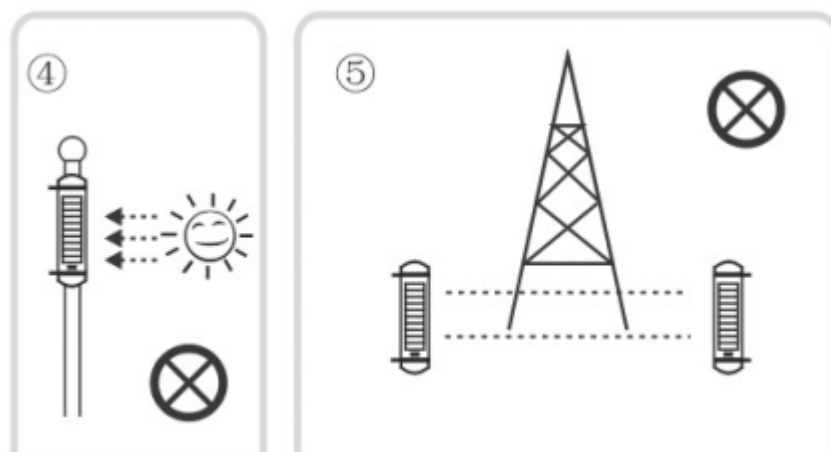

Note 4: Keep the Infrared light hole exposed to direct sunlight.

Note 5: The high-voltage tower and the signal tower may influence wireless

transmission distance.

Other Important Precautions

- ① Before installation, remove the plastic film on the solar panel of the light wall.
- ② Never install this light wall near door access systems, passages, areas prone to trigger an alarm, or areas which could trigger an alarm more than 50 times per 24 hours.
- ③ This product is a solar-powered wireless product, so it shall not be installed, tested or operated indoors or in any dark place with a sunlight intensity of less than 2200lux.
- ④ This product can trigger an alarm less than 50 times when this product is tested under normal sunlight conditions. Never try to test maximum alarm times indoors, otherwise, it may cause batteries subject to low voltage problem, which may impede normal operation of this product, and even cause damage to this product.
- ⑤ Before first operating this product, please follow the technical guide provided by the supplier.

Special Statement: Any loss resulting from failure or damage caused by improper use or failure to observe precautions or instruction manual shall be borne by users.

4、 Operating Phenomena

① Short press the ON/OFF button at the rear of the transmitting terminal <F> and the receiving terminal <S> N times (N=3-10), and after about 3 seconds, there are 3-8 beeps respectively from the transmitting terminal <F> and the receiving terminal <S> of the multi-beam light wall, and at the same time, the indicator lamp of the multi-beam light wall will flash 3 times, which signifies the multi-beam light wall is normally powered on. When the “ON/OFF” key is pressed, it means the light wall is turned on if there is a “Beep” sound prompt.

② Once normal prompt is given out at start-up, the indicator lamp at the transmitting terminal <F> is continuously on for 30 seconds and then goes out, and the receiving terminal <S> will light up for a long time. Keep the transmitting terminal <F> aligned with the receiving terminal <S>. If the indicator lamp at the receiving terminal <S> flashes for 30 seconds and then goes out, it signifies the multi-beam light wall is normally operating.

③ After the indicator lamp at the receiving terminal <S> normally goes out, block up three infrared holes of the light wall with thick materials, let the receiving terminal <S> transmit wireless alarm signals, the indicator lamp at the receiving terminal will light up for about 5 seconds, and then the indicator lamp at the receiving terminal will flash for 30 seconds, which signifies the multi-beam light wall is operating again. Repeat the above-mentioned steps.

④ Press the ON/OFF button at the rear of the transmitting terminal <F> and the receiving terminal <S> N times (N=3-10), and after about 3 seconds, there are long beeps lasting for about 10 seconds respectively from the transmitting terminal <F> and the receiving terminal <S> of the multi-beam light wall, and at the same time, the indicator lamps at the transmitting terminal <F> and the receiving terminal <S> will light up, and later beeps stop and indicator lamps go out, which signifies the

multi-beam light wall is normally powered off. When the “ON/OFF” key is pressed again, it means the light wall is turned off if there are two “Beep, Beep” sound prompts.

Other Precautions

- ① In normal operation state, when the “ON/OFF” key is pressed twice, a turn-off signal will be sent after an alarm signal is transmitted.
- ② If the receiving terminal fails to receive the infrared light pulse emitted by the transmitting terminal, the indicator lamp at the receiving terminal will light up continuously for 30 minutes, and then go out. Once the receiving terminal has received the infrared light pulse emitted by the transmitting terminal, the indicator lamp at the receiving terminal will light up intermittently, and then flash, which signifies the multi-beam light wall is normally operating.
- ③ After the multi-beam light wall is normally powered on, if no natural light or light with an intensity of more than 2200LX is reflected onto the multi-beam light wall every 100 hours, the multi-beam light wall will be automatically powered off.
- ④ For the finished multi-beam light wall, the transmitting terminal has been well paired with the receiving terminal. Any unauthorized pairing of the transmitting terminal and the receiving terminal is impermissible. If any special circumstance occurs, please contact the manufacturer or distributor immediately.
- ⑤ Never put the multi-beam light wall in any dark place or cover the solar panel with any materials at power-on, otherwise, the multi-beam light wall may not be normally powered on.
- ⑥ Press the ON/OFF button of the multi-beam light wall to confirm if the multi-beam light wall is under power on or power off mode. If a beep prompt is given out, it means the multi-beam light wall is under power on mode, otherwise, it is under power off mode.

5、 Installation Procedures

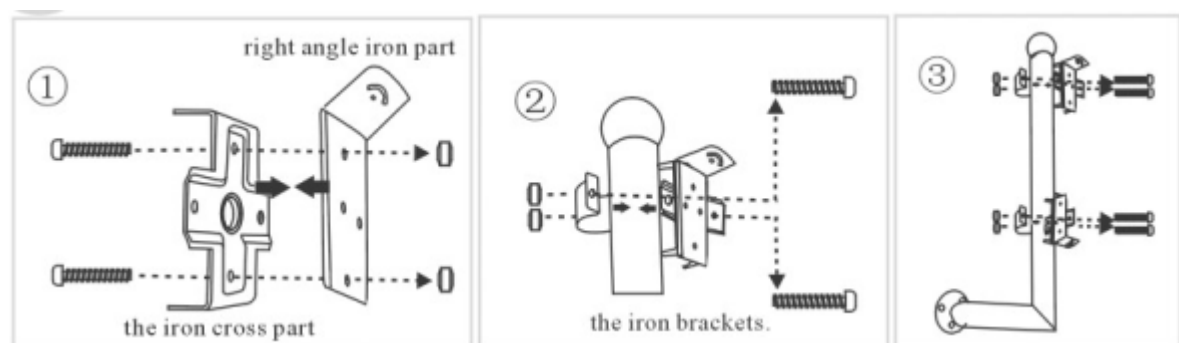

- ① Fasten the iron cross part and right angle iron part with screws, and ensure installation direction of screws is correct.
- ② Fasten the arc-shaped iron holder and the iron cross holder in iron brackets.
- ③ Fasten the other set of iron parts in the iron bracket in the same way as mentioned above according to height of the light wall.

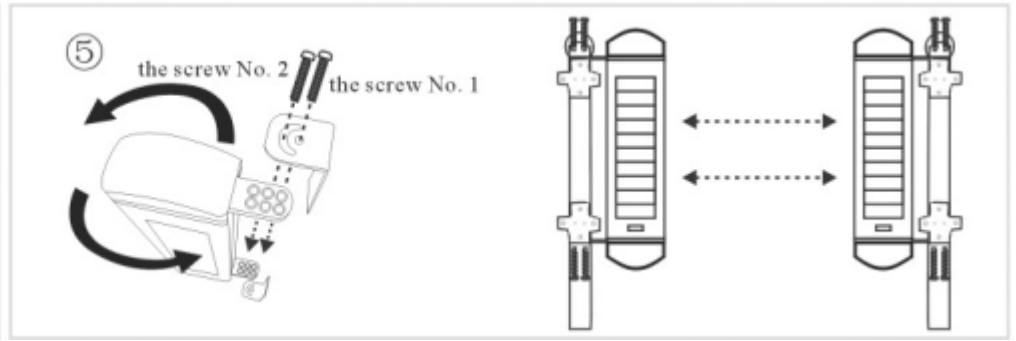
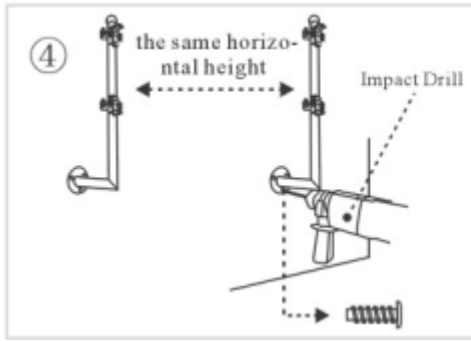

- ④ Determine a suitable installation height, make holes in wall with a percussion drill, and then fasten iron brackets in wall with metal screws. Try to keep two brackets respectively for transmitting terminal and the receiving terminal of the light wall in the same horizontal height.
- ⑤ Get the wide temperature range active wireless infrared light wall prepared for installation, tighten screw No. 1, and adjust the light wall to ensure the transmitting terminal <F> and the receiving terminal <S> are located in the same vertical and horizontal planes. If any deviation occurs during calibration, move two terminals left or right. Determine suitable position for screw holes, keep the transmitting terminal aligned with the receiving terminal, and finally tighten screw No. 2. For more calibration precautions, please refer to Part VI in User Manual.

6、 Installation & Calibration Precautions and Test Methods

Calibration Precautions

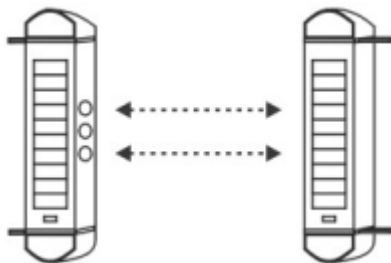

- ① Make sure that the power switch of the active light wall is turned on.
- ② Make sure that the light wall is normally operating.
- ③ Fasten the light wall in iron brackets with screws through screw holes in the cap peak. Fasten and tighten screw No. 1, and move two terminals left or right according to light wall calibration requirements, keep the transmitting terminal aligned with the receiving terminal, and finally tighten screw No. 2.

Test Method for Verifying if the Light Wall is Well Mounted

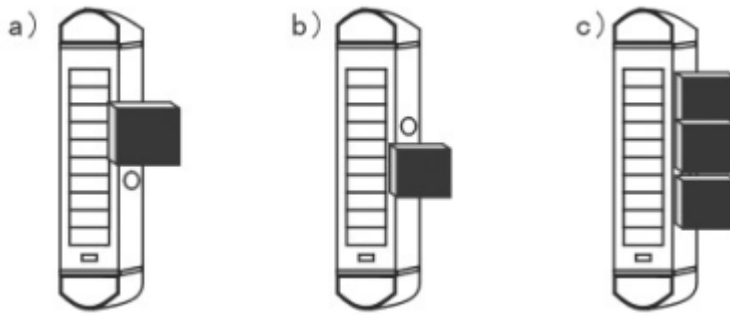

①Verify if the detector is normally operating by confirming if the indicator lamp of the light wall normally flashes.

②Hole Block-up:

a) The light wall does not alarm when two infrared light holes at the upper end of the light wall are blocked up.

b) The light wall does not alarm when two infrared light holes at the lower end of the light wall are blocked up.

c) The light wall alarms when three infrared light holes are blocked up.

Alarm Mode



①Infrared light holes are not completely blocked up (Fingers do not completely block up the infrared light holes at the transmitting terminal and the receiving terminal when keeping the transmitting terminal aligned with the receiving terminal).

②The light wall does not alarm if the intruding object moves under free fall.

③The infrared light holes of the light wall are completely blocked up for more than 1s by thick materials.

Note: If the host can receive alarm information when the light wall correctly alarms more than 3 times, that indicates the light wall is well installed.

7、 Check for Abnormality

Failure Symptoms	Failure Reasons	Failure Recovery Methods
The multi-beam light wall does not alarm, but the alarm lamp lights up	①The light holes of the multi-beam light wall are not completely blocked up.	Completely block up infrared light holes with thick materials
	②The host is not armed.	Arm the host by remote control, and then trigger an alarm

	③The antenna of the host is not retracted, and wireless distance does not conform to product specifications.	Retract the antenna
	④The multi-beam light wall does not automatically learn code with the host.	Keep the multi-beam light wall automatically learn code with the host
The alarm lamp of multi-beam light wall does not light up	①The multi-beam light wall has been not calibrated for a long time, and battery protection works.	Calibrate the multi-beam light wall again
	②The battery voltage of multi-beam light wall is too low, so that the multi-beam light wall automatically runs in battery protection mode.	Charge the multi-beam light wall in a sunny place. Return batteries to the manufacturer if batteries fail to work.
	③If the alarm lamp does not light up, but the multi-beam light wall can alarm, it means the lamp does not work.	Return the alarm lamp to the manufacturer
The multi-beam light wall does not normally work when powered on	① Inappropriately powered on	Check if the active infrared light wall works normally when powered on
	② Not keep the transmitting terminal of the light wall aligned with the receiving terminal of the light wall.	Keep the transmitting terminal of the light wall aligned with the receiving terminal of the light wall.
The multi-beam light wall gives out a prompt sound lasting for 2 seconds when powered on	①The battery voltage of multi-beam light wall is too low	Charge the light wall in a sunny place.
	②When powered on, the light wall shall be kept in a shady place or the solar panel of the light wall shall be covered with something.	Make sure the solar panel of the light wall is kept in a sunny place when turning on the light wall.
The multi-beam light wall does not give out a sound prompt when powered on	①Any operation error occurs when pressing the ON/OFF button	Press the ON/OFF button in a proper way
	②The multi-beam light wall is kept in a dark place or the solar panel is covered with any materials when powered on.	Keep the multi-beam light wall in a sunny place when powered on
	③The multi-beam light wall does not work.	Return the multi-beam light wall to the manufacturer

8、 Technical Parameters

Technical Parameters	Solar-Powered Multi-beam Active Wireless Infrared Light Walls
Infrared Distance	100m
Wireless Transmitting Distance	HB-T001Q3 100m HB-T001R3 1km
Wireless Transmitting	FM:433MHz

Frequency	
Maximum alarm times in 24 hours	Not more than 50 times
Battery Capacity	500mAh (Transmitting Terminal), 1000mAh (Receiving Terminal)
Working environment temperature range	-30°C~70°C
Number of infrared beams	3beams
Operating Voltage	3.3V
Static Operating Current	Transmitting terminal $\leq 0.5\text{mA}$, receiving terminal $\leq 0.5\text{mA}$
Infrared light frequency	secondary modulation & encoding based on 38KHZ
Infrared light wavelength	940nm \pm 20nm
Solar electric panel output current	$\geq 2\text{mA}$ at a light intensity of 1800LX (Note: The outdoor light intensity in cloudy or rainy days is about 2000LX)

9、 Dimension

