

SP-7929

NEW



Fanless and Low Power 19" Intel® Atom™ D2550 Panel PC



Features

- Support Intel® Atom™ D2550 (1.86 GHz, 1M Cache)
- Memory Support 204 Pins SO-DIMM, DDR3 800/1066 MHz, up to 4GB
- Dual Ports to support 10/100/1000 Mbps and Wake on LAN
- Supports 2 x SATAII, 6 x USB 2.0 port, 4 x Serial port, DIO 4 in / 4 out and 1 x Parallel port
- Support dual PCI expansion Slot (PCIe to PCI riser card)
- Fanless Panel PC
- Easy maintenance (modular design)
- Optional slim DVD drive
- Stainless steel front bezel



Specifications

System

CPU Type	Intel® Atom™ D2550 CPU on board
Chipset	NM10
Memory Support	1 x 204 Pins SO-DIMM, DDR3 up to 4GB
Front Bezel	Stainless steel (SUS 304)
IP65	Yes (for front panel only)
Watchdog	1~255 secs Watchdog timer selectable
Power Supply	ATX 130W power supply
Operating System	Windows 7
Dimension (W x H x D)	497 x 420 x 93.4 mm
System Weight	10.2 Kg
VESA Mounting Support	75 mm / 100 mm VESA bracket (optional)
Certificate	FCC / CE

I/O Ports

Display	1 x VGA
USB	6 x USB 2.0
Audio	1 x Line-in / Line-out / Mic in
LAN	2 x LAN (10/100/1000 Mbps)
	4 x COM ports
Serial Port	COM 1/3/4 for RS232 COM 2 for RS232/422/485 selectable (All COM ports support +5V / +12V selectable)
Parallel Port	1 x Parallel port (SPP / EPP / ECP)
Digital I/O	4-in / 4-out (with 5V and 12V)
Keyboard / Mouse	1 x PS/2 port
Drive Bay	2 x 2.5" SATA HDD or 1 x 2.5" SATA HDD + 1 x slim DVD (optional)
Expansion Slots	2 x PCI slot (optional)

Display

LCD	19" LED backlight 300 nit LCD, resolution 1280 x 1024
Touch Screen	(ELO) 5W Analog resistive (USB interface)

Environment

Operation Temp.	0° ~ 40°C (32° ~ 104°F)
Storage Temp.	- 20° ~ 80°C (- 4° ~ 176°F)
Humidity	20% ~ 90%

*All information contained in this document is subject to change without prior notice. Please log on www.protech.com.tw to acquire latest information.

I/O Panel View

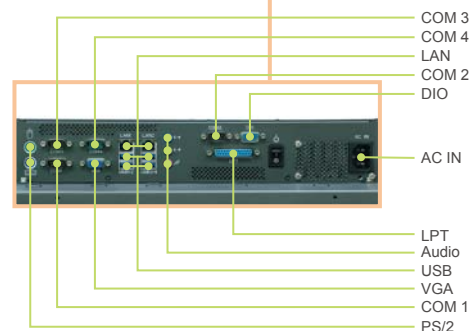
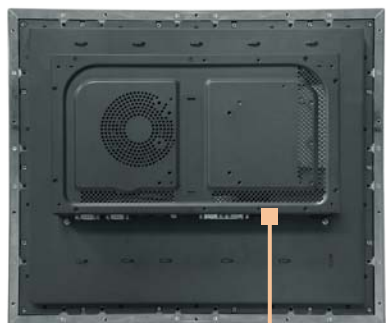

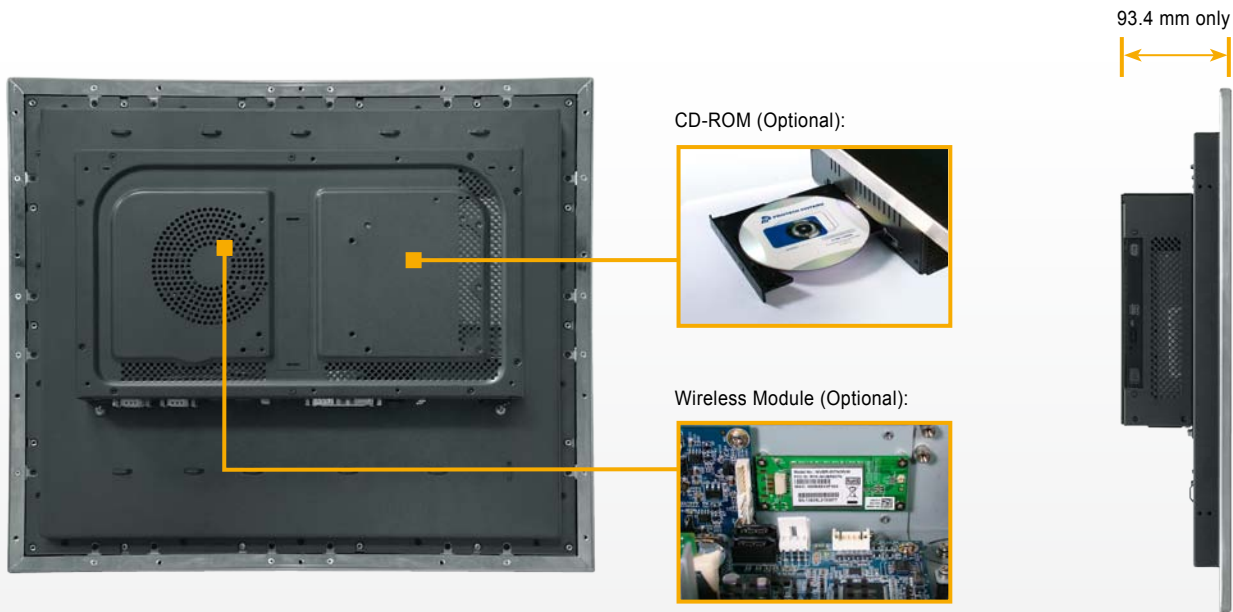

Ordering Information

Order No	Description
SP-7929RA-A0B	HSF, Intel® Atom™ D2550+ NM10 Fan-less Panel PC, w/19" Panel 1280*1024 / 5-Wire ELO Touch
SP-7929RA-B0B	HSF, Intel® Atom™ D2550+ NM10 Fan-less Panel PC, w/19" Panel 1280*1024 / Tempered Glass
SP-7615RZ-CR0	HSF, Only slim DVD bracket kit for SP-76xx and SP-79xx series
SP-7615RZ-DR2	HSF, Slim DVD and bracket kits for SP-76xx and SP-79xx series
SP-7615RZ-RC1	HSF, 2 PCI slot riser card and bracket kits (w/o package) for SP-76xx and SP-79xx series
SP-7615RZ-RC2	HSF, 2 PCI slot riser card and bracket kits (w/ package) for SP-76xx and SP-79xx series
SP-7615RZ-VM0	HSF, VESA bracket kit (w/ package) for SP-76xx and SP-79xx series
SP-7615RZ-VM1	HSF, 2 PCI slot riser card and VESA bracket kit (w/ package) for SP-76xx and SP-79xx series
SP-7915RZ-WL2	HSF, Wireless module kit for SP-76xx and SP-79xx series (802.11 a+b+g+n) (w/ 5DB Antenna 2pcs)

Applications

- Factory Automation
- Human Machine Interface

Dimensions

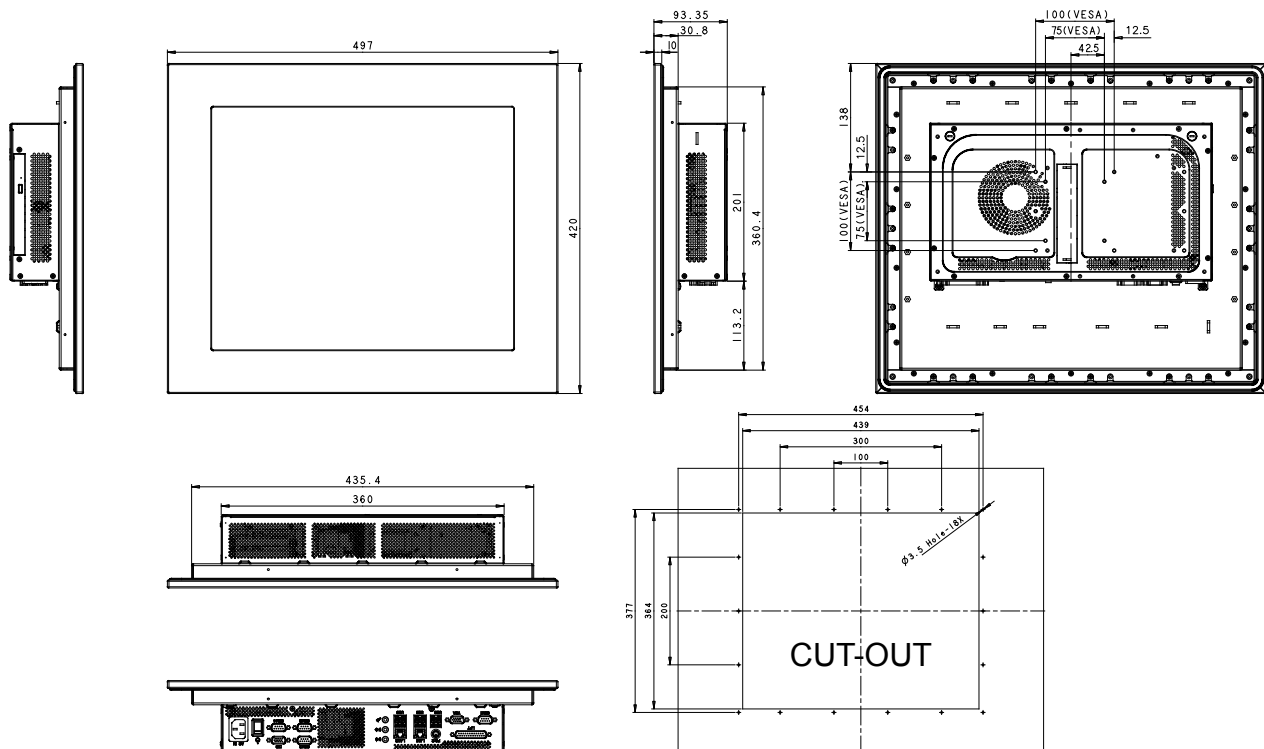

Unit: mm