

*ROHS

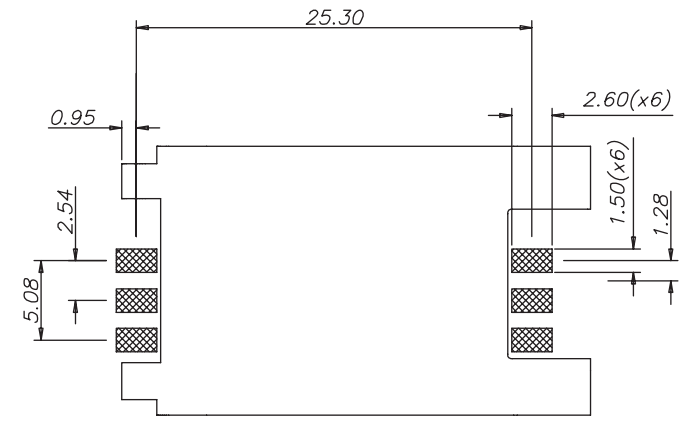

RECOMMEND PCB LAYOUT
TOLERANCE ± 0.05MM
TOP VIEW

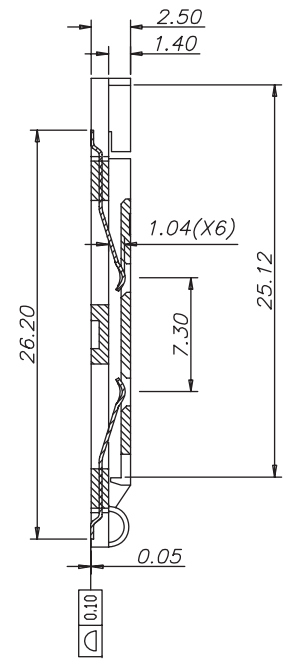
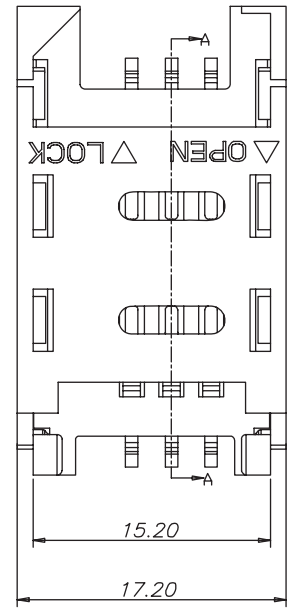
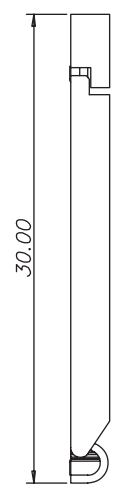
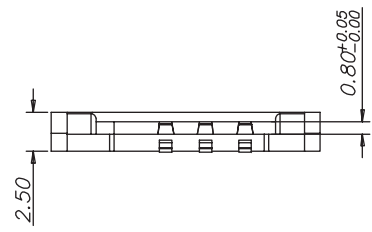

SEC A-A

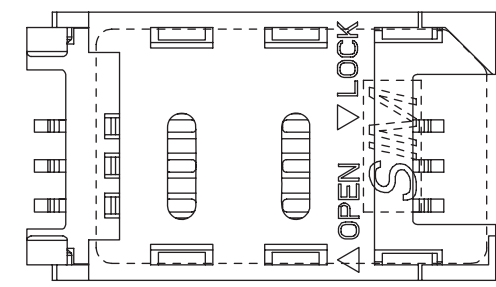
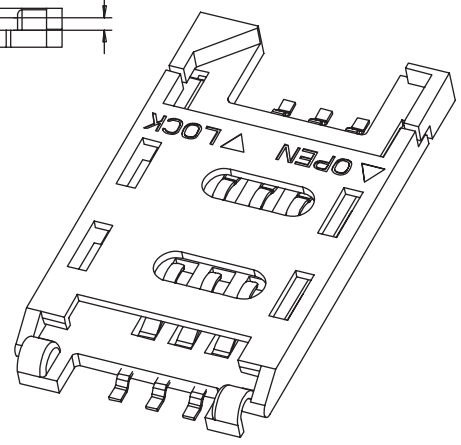

STAT OF LOCK

- A. Material:**
1. Insulator: High temperature thermoplastic 9T UL94V-0, (BLACK)
 2. Pho. Bronze: Plating, 50-80U" MIN NICKEL UNDERPLATED; 1-3U" GOLD ON THE CONTACT AREA; 80U" TIN PLATING ON SOLDER TAIL
- B. Electrical specifications:**
- Voltage rating: 12 V AC
 - Current rating: 0.5A
 - Dielectric strength: 500V AC for 1 minute min
 - Insulation resistance: 1000 M ohm
 - Contact resistance: 50 mill.ohm max
 - Operation temperature: -40°C to +105°C
 - Product withstanding rff low soldering 260°C for 10s
- C. Mechanical speieications:**
- 3.1 Durability: 5000 cycles

Secon International Enterprise Co., Ltd.

TOLERANCES			PROJECTION	TITLE		
x.	= ±	----		SIM Card Connector Hinge Type All Plastic		
x.x	= ±	0.38				
x.xx	= ±	0.25				
x.xxx	= ±	0.10				
			UNIT			
			mm			
DRAWN	COCO	DATE	2012/03/10	PART NO.	SIM-SF2160003	
SCALE	1:1	SIZE	A4	SHEET	1/1	REV A

REVISION NO.	ECR NO.	DESCRIPTION	MARK	DATE
1				
2				
3				
4				